



CORINTHIA

ST PETERSBURG



Grand in every sense of the word, three majestic 19th-century buildings and 388 rooms make up Corinthia St Petersburg, the place that could be home to your next event.

Our aim is to create the perfect platform for your event, and we take pride in achieving this time and time again. We understand your meeting or occasion is an investment, and we run both small gatherings and landmark occasions with the same level of precise efficiency. But don't just take our word for it, we've been named Russia's leading conference hotel at the 'World Travel Awards' seven times.

We invite you to discover the magic of Corinthia St Petersburg for yourself.

GDS CODES:

AMADEUS (1A) IALDNEV | GALILEO (UA) IA11451 | SABRE (AA) IA46249 | WORLDSPAN (1P) IACNEV

CORINTHIA ST PETERSBURG, NEVSKY PROSPECT, 57 ST PETERSBURG, 191025 RUSSIA

+7 812 380 2001 | RESERVATIONS.STPETERSBURG@CORINTHIA.COM

[CORINTHIA.COM/STPETERSBURG](https://www.corinthia.com/stpetersburg)



ROOMS & SUITES

- 388 ROOMS, SOME WITH VIEWS ACROSS THE ICONIC NEVSKY PROSPECT

RESTAURANTS & BARS

- IMPERIAL RESTAURANT, A FINE RESTAURANT OVERLOOKING THE NEVSKY PROSPECT
- CAFÉ VIENNA, FOR ALL-DAY LIGHT BITES
- LOBBY BAR, A COCKTAIL BAR

FACILITIES & SERVICES

- DRY CLEANING AND LAUNDRY SERVICES
- SECURE PARKING FACILITIES
- LIMOUSINE SERVICE
- 24-HOUR IN-ROOM DINING
- 24-HOUR WAKE-UP SERVICE
- FITNESS CENTRE
- 17 MEETING ROOMS WITH A TOTAL CAPACITY OF 1,000
- BUSINESS CENTRE
- ST PETERSBURG'S LARGEST BALLROOM
- EXECUTIVE CLUB LOUNGE
- COMPLIMENTARY WI-FI

First Floor

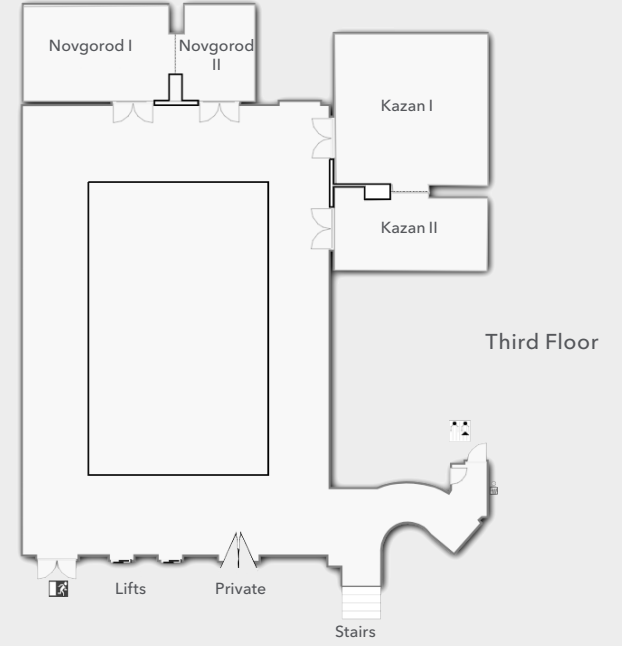
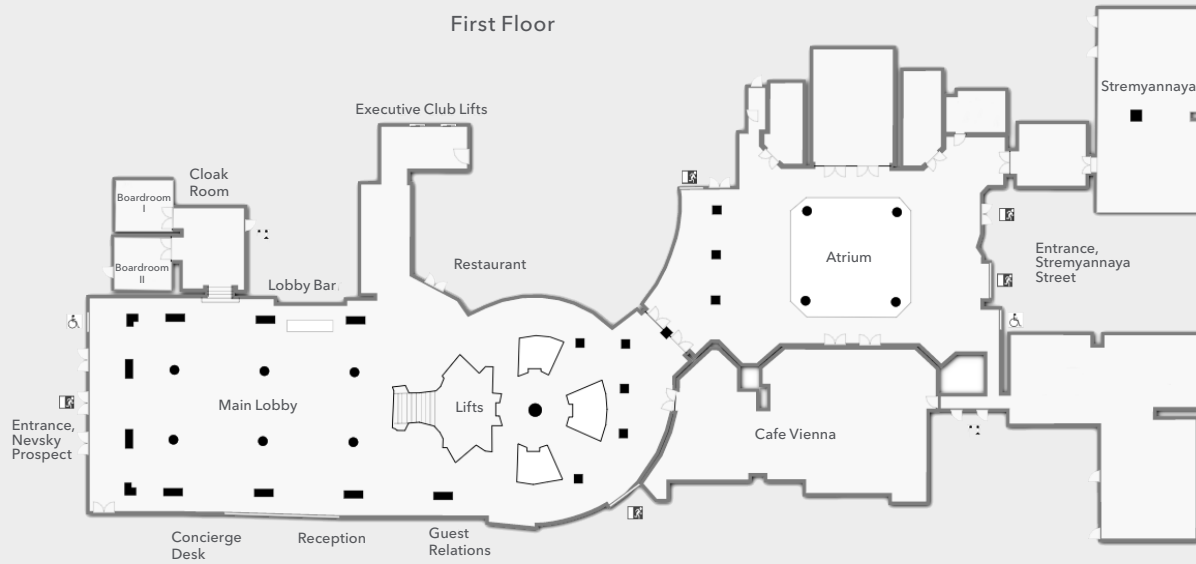



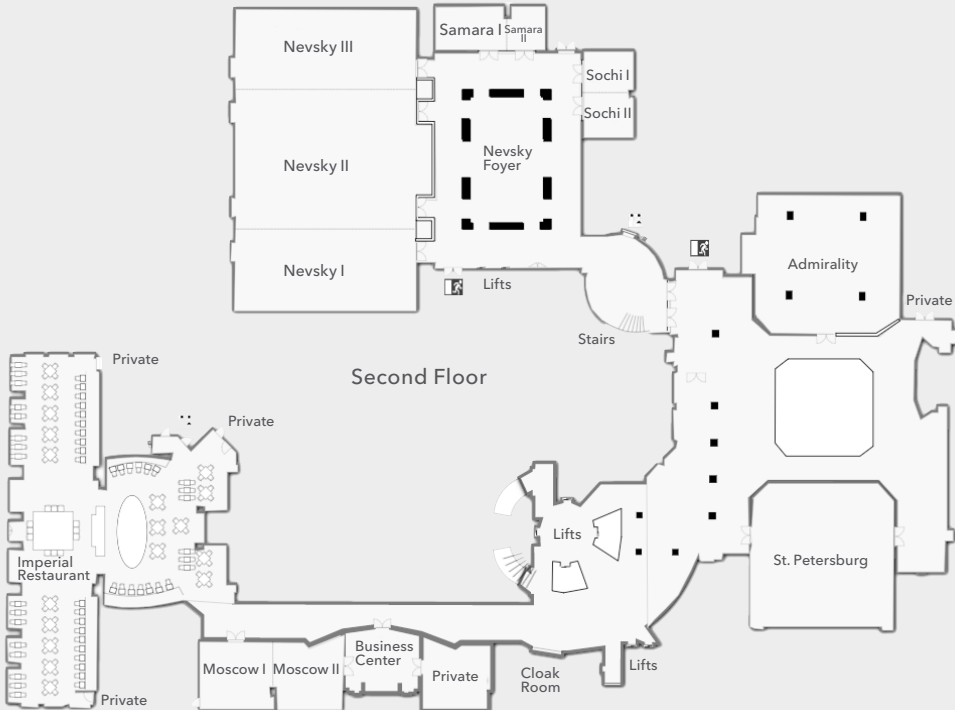



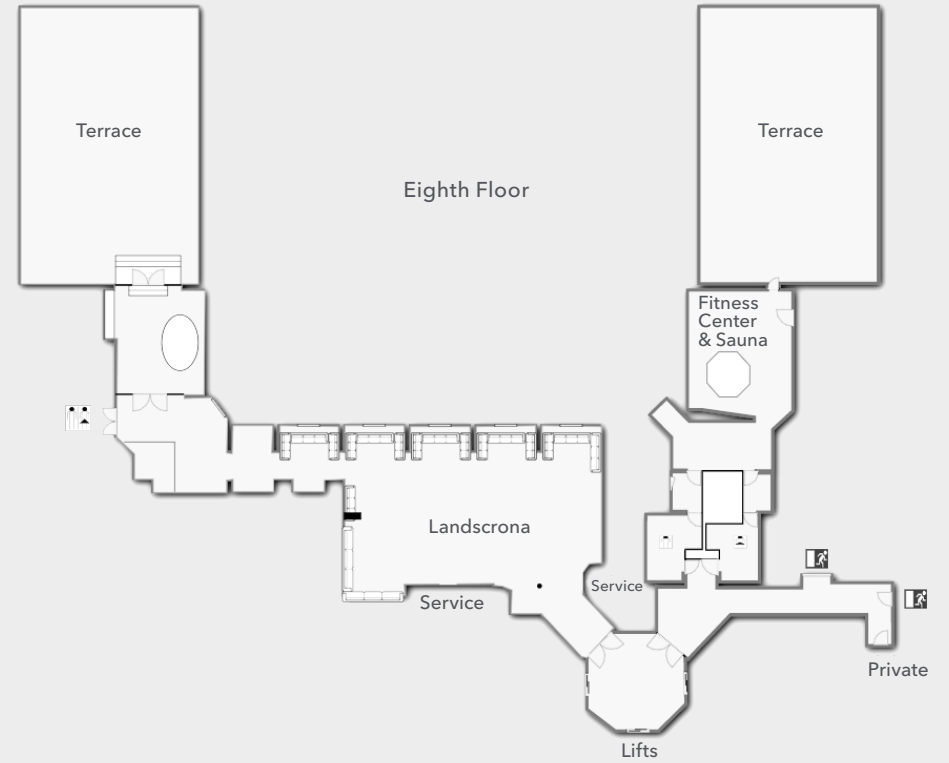

Third Floor



Second Floor



Eighth Floor

ROOM NAME	AREA, m ²	AREA, ft ²								
NEVSKY BALLROOM	525	5,652.6	600	330	300	84	100	0	560	320
IMPERIAL	428	4,508.2	0	0	0	0	0	0	0	0
NEVSKY BALLROOM I-II	385	4,139.1	392	240	180	60	75	0	400	240
NEVSKY BALLROOM II-III	385	4,138.5	392	240	180	80	66	0	400	240
NEVSKY FOYER	366	3,944.8	0	0	0	0	0	0	0	0
LANDSCRONA	356	3,834.4	70	30	60	20	20	0	100	30
NEVSKY BALLROOM II	244	2,625.1	300	135	140	70	54	0	260	0
ST PETERSBURG FOYER	200	5,636.1	0	0	0	0	0	0	0	100
ST PETERSBURG	192	2,070.0	180	90	110	40	42	64	150	80
STREMYANNAYA	142	1,529.5	70	30	40	0	21	0	80	30
NEVSKY BALLROOM I	141	1,514.0	100	54	70	50	45	0	150	60
NEVSKY BALLROOM III	141	1,513.5	100	54	70	50	45	0	150	60
ADMIRALTY	110	158.4	96	45	60	22	30	0	120	50
MOSCOW I-II	96	1,028.6	65	40	60	30	0	0	80	24
KAZAN I-II	72	768.9	0	0	0	24	0	0	0	0
MOSCOW II	49	506.0	40	20	30	18	18	0	40	14
KAZAN I	48	511.0	0	0	0	14	0	0	0	0
MOSCOW I	47	522.5	40	20	30	18	18	0	40	14
NOVGOROD I-II	46	485.8	0	0	0	12	0	0	0	0
SAMARA I-II	45	483.3	0	0	0	12	0	0	0	0
SOCHI I-II	39	425.7	0	0	0	16	0	0	0	0
NOVGOROD I	31	329.4	0	0	0	10	0	0	0	0
SAMARA I	31	328.7	0	0	0	10	0	0	0	0
BOARDROOM I	26	282.2	0	0	0	10	0	0	0	0
KAZAN II	24	257.9	0	0	0	10	0	0	0	0
SOCHI II	20	219.0	0	0	0	8	0	0	0	0
BOARDROOM II	19	208.2	0	0	0	10	0	0	0	0
SOCHI I	19	206.6	0	0	0	8	0	0	0	0
NOVGOROD II	15	156.4	0	0	0	0	0	0	0	0
SAMARA II	14	154.6	0	0	0	0	0	0	0	0